

# JBC 325

► [www.javabrewcollection.com](http://www.javabrewcollection.com)

## User Interface

- Tactile selection panel (Soft Touch Technology) with 12 push buttons that can be configured both as selections or pre-selections.
- Showcase for introduction of fresh coffee beans or for branding.
- End selection acoustic signal.
- 32 digit alphanumeric display.
- 6.69" 170 mm high delivery area suitable for mug or jug and foldaway espresso cup support.



## TECHNOLOGY



LED, LOW VOLTAGE  
LIGHTING



PATENTED  
ESPRESSO GROUP

Tabletop or cabinet, plumbed or internal refillable tank, perfect for small to medium size accounts.

**JBC**  
Java Brew Collection

## JBC SERIES 325 SPECIFICATIONS

### ELECTRICAL SUPPLY

AC Voltage = 120 V – 60 Hz

### INTERNAL ELECTRICAL SUPPLY

All the electrical components are supplied at 24 Vdc, with the exception of the boiler resistances, the pump and the steam ventilator that are powered by the mains voltage.

### POWER SUPPLY

- 1.80 kW single boiler espresso version
- 1.80 kW alternating double boiler espresso version
- 2.80 kW double boiler espresso version
- 2.25 kW instant version

### WATER SUPPLY

Fitting connection = 3/4"

Water pressure = 0.5 – 6.5 bar

JBC 325  
ESPRESSO

1. FRENCH VANILLA
2. COFFEE
3. MILK
4. CHOCOLATE

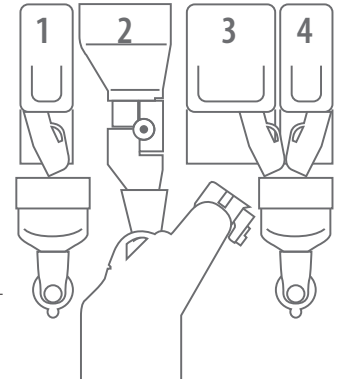

JBC SERIES 325	E3S ESPRESSO SINGLE BOILER *	E3S ESPRESSO DOUBLE BOILER *	I5S INSTANT *
COFFEE BEANS	1	1	-
INSTANT CANISTERS	3	3	5
<b>DIMENSIONS</b>	H 24.6: (625 mm) x W 15.55" (395 mm) x D 22.8" (580 mm) WEIGHT 69.4 LBS (31,5 kg)		
<b>CABINET</b>	H 35.4" (900 mm) x W 15.74" (400 mm) x D 23.2" (590 mm)		

\* all versions are available with water system supply or with autonomous tank

## FEATURES

- Great flexibility of configuration and a wide choice of versions with water system supply or with autonomous tank.
- Mixers and boiler assembly are extractable to make maintenance operations easier.
- Standard boiler for Espresso: 1500 W – 150 cc. Double boiler available by adding a boiler 700 W – 180 cc. for higher performances (long drinks).
- Boiler for instant: 2000 W - 3,6 litres.
- Liquid waste tray: 1.9 litres with visible signal for maximum water level.
- Coffee waste tray: 60 pods with counter software management.

## PRODUCT CAPACITY

	single canister	double canister
Coffee beans	1.76 Lbs (0.8 kg)	-
Instant coffee	1 Lbs (0.45 kg)	-
Powder milk	1.2 Lbs (0.55 kg) (1.75 lt)	3 Lbs (1.4 kg) (3.5 lt)
Whitener	2.6 Lbs (1.2 kg) (1.75 lt)	6.4 Lbs (2.9 kg) (3.5 lt)
Chocolate	1.3 kg (1.75 lt)	6.6 Lbs (3 kg) (3.5 lt)
Lemon tea	2.8 Lbs (2 kg) (1.75 lt)	-
Tea	2.2 Lbs (1 kg) (1.75 lt)	-
Soup	2.75 Lbs (1.25 kg) (1.75 lt)	-
Sugar	3.7 Lbs (1.7 kg)	-

## PAYMENT SYSTEM

- Compatible with validator or cashless system - parallel protocols, EXE, MDB.

## ACCESSORIES KIT

- Equipped cabinet.
- Free vend panel.
- RS232 module.
- EXE/MDB kit.
- Visual Smart Programmer Speed that allows the upload of the firmware and settings and the download of the settings and audit without a PC.
- Cup stations lighting kit through by software.

## ENVIRONMENT

- Backlighted keyboard with led.
- In compliance with ROHS and WEEE.

